

Marketing Preview



95 St. Matthews Close, Renishaw, Sheffield, S21 3WT
£110,000

Bedrooms 2, Bathrooms 1, Reception Rooms 1



CHAIN FREE! Deceptively spacious two-bedroom first floor apartment, ideal for a first-time buyer, investor, or someone looking to downsize. The property offers allocated parking, a large lounge/diner with an off-shot kitchen, and is ready to move into. Conveniently located with road links to Chesterfield, Sheffield, and the M Motorway.

SUMMARY

CHAIN FREE! Deceptively spacious two-bedroom first floor apartment, ideal for a first-time buyer, investor, or someone looking to downsize. The property offers allocated parking, a large lounge/diner with an off-shot kitchen, and is ready to move into. Conveniently located with road links to Chesterfield, Sheffield, and the M Motorway.

Secure intercom system to the communal entrance door. A welcoming hallway leads into the flat, giving access to a large and bright lounge/diner and an off-shot kitchen. There is a good-sized double bedroom and a generous single bedroom, along with a bathroom featuring a bath with an overhead shower, pedestal sink, and close-coupled WC.

Outside, there is an allocated parking space along with additional visitor parking.

PROPERTY DETAILS

- LEASEHOLD, 976 YEARS REMAINING, £40PA GROUND RENT, £1438.82PA SERVICE CHARGE
- FULLY UPVC DOUBLE GLAZED
- GAS CENTRAL HEATING
- COMBI BOILER
- COUNCIL TAX BAND B - NORTH EAST DERBYSHIRE COUNCIL

FOR ROOM MEASUREMENTS PLEASE SEE THE FLOORPLAN

First Floor

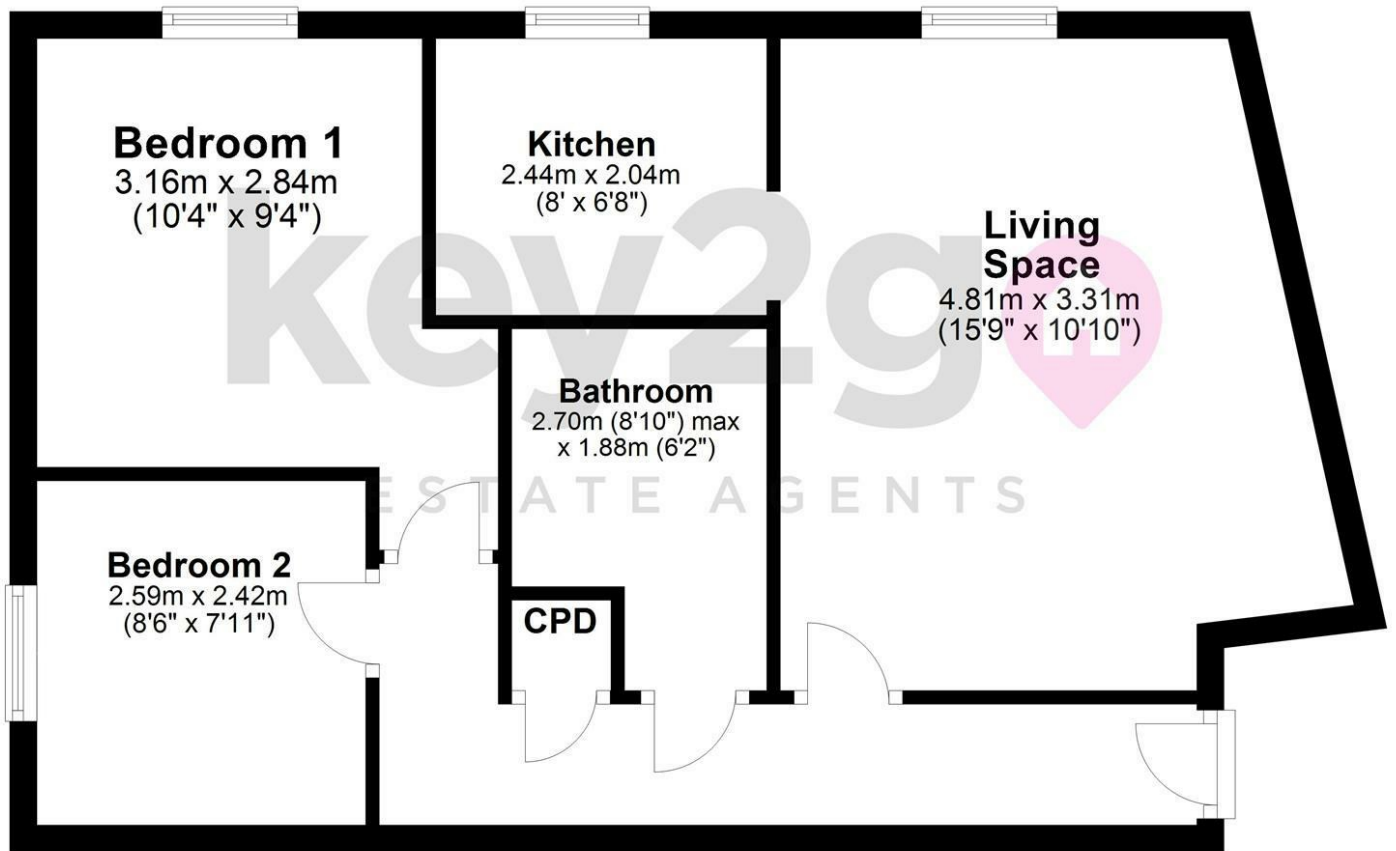

Energy Efficiency Rating

	Current	Potential
Very energy efficient - lower running costs		
(92 plus) A		
(81-91) B	82	82
(69-80) C		
(55-68) D		
(39-54) E		
(21-38) F		
(1-20) G		
Not energy efficient - higher running costs		
England & Wales	EU Directive 2002/91/EC 